

C-19/EM-7.5 LCO2

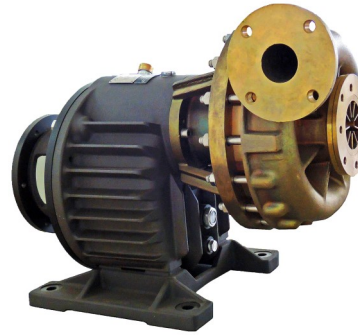

C-25/G2-H LCO2



Technical Data

Model	C-19/EM-7.5 LCO2	C-25/G2-H LCO2
Application	truck / trailer off-loading liquid storage transfer	
Liquid	LCO2	
Seal	GRD	
Cold end	C-19	C-25
Impeller diameter	190 mm	250 mm
Rotational speed	2950 rpm	up to 6200 rpm
Flowrate range	100-500 l/min	100-600 l/min
Suction pressure	up to 24 bar	
Outlet pressure	up to 28 bar	up to 65 bar
Power transmission	direct driven 400 V / 16 A	gearbox G2
Drive	7.5 kW electric drive	hydraulic system of the trailer (not included) up to 75 kW

Features

- ▶ Pumps designed for high pressure
- ▶ Diffusor technology for high efficiency and low bearing load
- ▶ High efficiency
- ▶ Inducer technology for low NPSHr
- ▶ Fast cool down due to light weight cold end
- ▶ Dedicated sealing for LCO2 application
- ▶ Extended lifetime of the proven SEFCO gearbox G2
- ▶ Designed for intermittent and continuous operation
- ▶ C-25 outlet pressure up to 65 bar
- ▶ LOX-approved cleaning procedures and assembly for all SEFCO pumps, irrespective of application

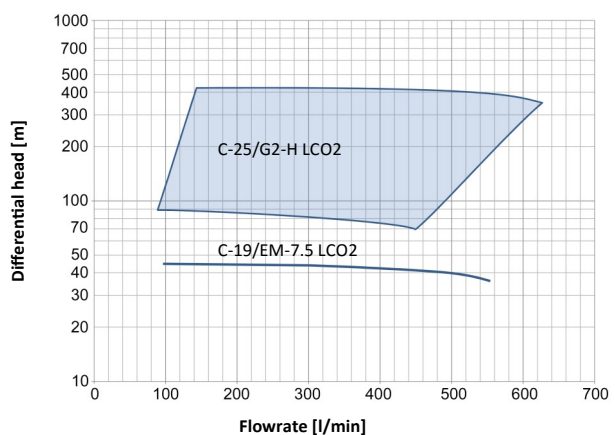

General Arrangement

all dimensions in [mm]

C-19/EM-7.5 LCO2

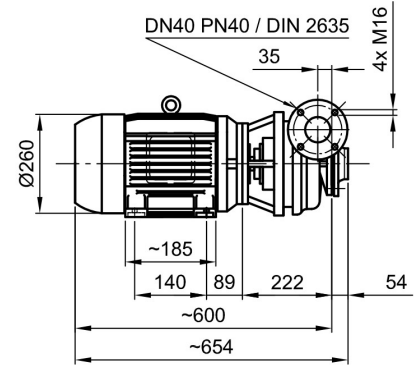
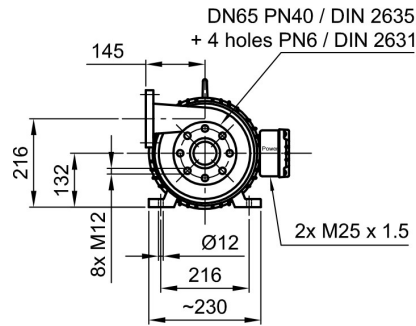

C-25/G2-H LCO2

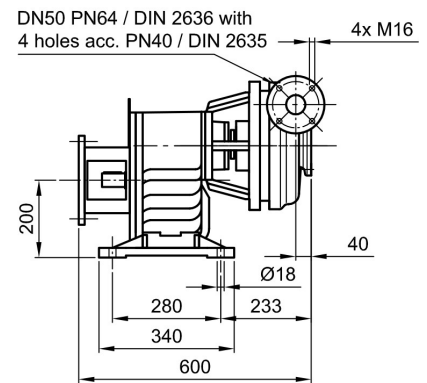
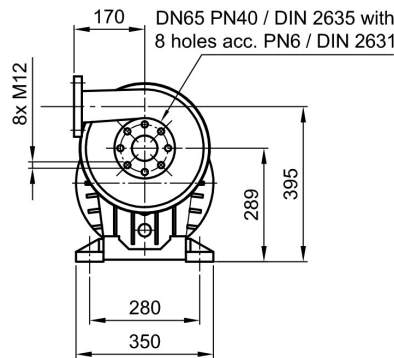

Scope of Supply

- ▶ Cold end type C-19 or C-25
- ▶ Inducer and vane ring for low NPSHr
- ▶ SEFCO mechanical seal GRD
- ▶ SEFCO gearbox type G2-H
- ▶ Connection to existing hydraulic powertrain

Options

- ▶ Dual PT100 for leakage detection
- ▶ Dual PT100 for cool down survey
- ▶ Nickel-coated cold end for special applications
- ▶ Various skid arrangements
- ▶ Recommended 2 years spare parts
- ▶ For C-25/G2-H hydraulic motor

sefco

HEADQUARTERS

Wuhrmattstrasse 15
4103 Bottmingen (Switzerland)
Tel.: +41 61 421 94 60
Fax: +41 61 421 57 75
info@sefco.ch
www.sefco.ch

WAREHOUSE AND FABRICATION

Sundgauerstrasse 1
4106 Therwil (Switzerland)
Tel.: +41 61 421 94 60
Fax: +41 61 421 57 75
info@sefco.ch
www.sefco.ch

Worldwide Representative Offices

CHINA

Torchlight Consulting LTD
Unit 3A, 5/F, Far East Cons. BLDG
121 Des Vœux Road
Hong Kong (China)
Tel.: +86 177 1752 1991
torchconsult@outlook.com

Nanjing Kepurui
Nanjing Yangtze River Ind. Dev. Zone
148 Xinhua Road
Nanjing (China)
Tel.: +86 177 1752 1991
torchconsult@outlook.com

USA

Texas Cryogenics
13223 Reeveston Rd.
TX 77039 Houston (USA)
Tel.: +1 281 987 0127
dfake@newquest.com

INDIA

Continental Cryogenics Pvt. Ltd.
No. 155, Jigani Link Road
560099 Bommasandra (India)
Tel.: +91 80 2783 1975
astlg1@conticryo.com

Europe Service Centers

GERMANY

Wehn Fahrzeugtechnik GmbH
Oberhausenerstrasse 5
57234 Wilnsdorf (Germany)
Tel.: +49 2737 3013 0
info@fahrzeugtechnik.de

AUSTRIA

Schwingenschlögel GmbH
Gewerbestrasse 12
5301 Eugendorf (Austria)
Tel.: +43 6225 83 44 0
office@schwingenschloegel.at

BENELUX

Eurotank GmbH
Wöhrmannstrasse 5
47546 Kalkar (Germany)
Tel.: +49 2824 9718 0
eurotank@eurotank.de

NETHERLANDS

Schenk Papendrecht B.V.
Postbus 1165
3350 Papendrecht (Netherlands)
Tel.: +31 78 644 2150
info@schenkbv.nl

SCANDINAVIA

Cryo Service Center
Knippekulen 3A
41749 Göteborg (Sweden)
Tel.: +46 31 124 940
order@cryosc.se

POLEN

Nexter Color System SP zoo
Tadeusza Kosciuski 61
43190 Mikolow (Poland)
Tel.: +48 32 203 06 65
biuro@nexter.com.pl

ITALY

Technoimpianti APM S.r.l.
Via Lombardia 2
24030 Medolago (Italy)
Tel.: +39 035 4948 222
info@tiapm.it

IBERIA

Cryogas s.l.
Xarol 34 B
08915 Badalona (Spain)
Tel.: +37 933 847 116
cryo@cryogas.es